

# 1 1/16" BORE CORROSION RESISTANT CYLINDER



## CR-SDD-17-□-□

Double Acting



Mount: Stud  
Type: Double Rod

Standard Stroke Lengths: 1", 2", 3", 4", 5", 6"  
Options: M, V, N, P6, P7, P8

For magnetic option add .312

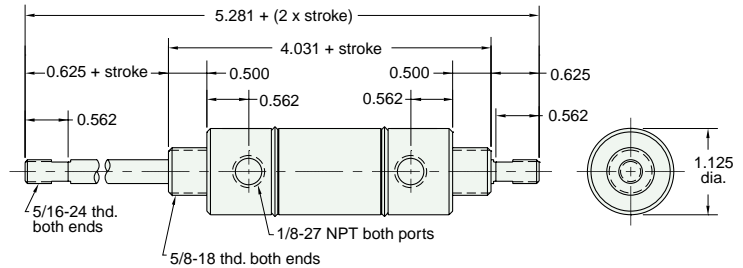

Furnished without nut(s). Order Part No. N10-18-SS.

## CR-SDR-17-□-□

Double Acting



Mount: Stud  
Type: Rotating Rod

Standard Stroke Lengths: 1/2", 1", 1-1/2", 2", 3", 4", 5", 6"  
Options: M, V, N

For magnetic option add .312

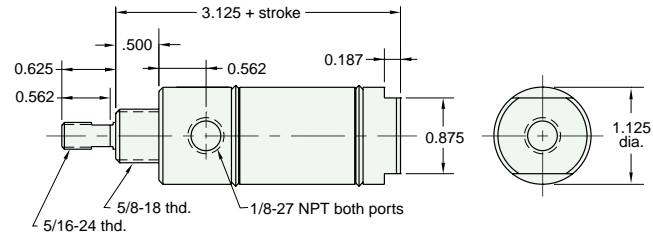

Furnished without nut(s). Order Part No. N10-18-SS.

## CR-UDR-17-□-□

Double Acting



Mount: Stud  
Type: Rotating Rod

Standard Stroke Lengths: 1/2", 1", 1-1/2", 2", 3", 4", 5", 6",  
Options: M, V, N, P2, P3, P4, P5, P6, P7, P8

For magnetic option add .312

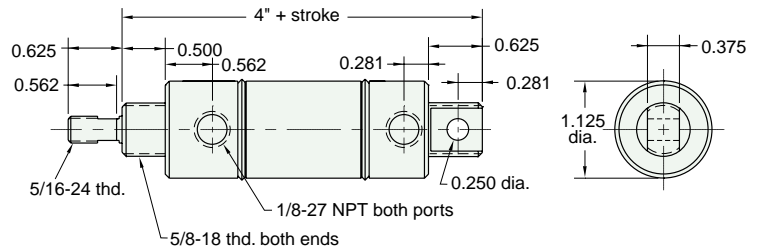

Furnished without nut(s). Order Part No. N10-18-SS.

## Stainless Steel Mounting

Foot Bracket  
Model Number: FB-1791-SS

Nut  
Model Number: N10-18-SS  
Max. Torque in lbs.: 12

